



enercare®
Experts at home™

Tankless Reverse Osmosis System Filter Replacement

 #1 Pre-Filter (Black)

 #2 Reverse Osmosis Membrane (Blue)

THIS PACKAGE CONTAINS THE PRE-FILTER AND REVERSE OSMOSIS MEMBRANE FOR YOUR TANKLESS REVERSE OSMOSIS SYSTEM. PLEASE FOLLOW THE STEPS BELOW TO REPLACE YOUR FILTERS.

Stage 1: Filter Replacement Set Up

NOTE: Start by clearing the area around your Reverse Osmosis System under the sink and ensure you have enough room to access the filters through the magnetic top cover of your system.

1

Close the main shut-off valve on the cold water supply line connected to the Tankless Reverse Osmosis System by turning it clockwise.

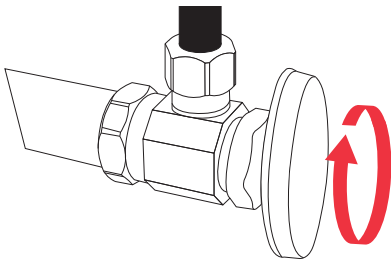

2

Open the faucet on the countertop to release all pressure to the Tankless Reverse Osmosis System, and leave the faucet open until you have replaced the required filters.

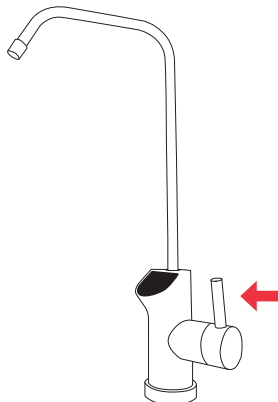

3

Depending on your model, pull off to remove cover of the Tankless Reverse Osmosis System and reveal the filters. For model A, place with the screen facing up to not damage the cover.

Model A



Model B

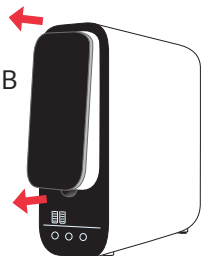

For more information please scan the QR code or visit **enercare.ca/tanklessfilters**



enercare[®]
Experts at home™

Tankless Reverse Osmosis System Filter Replacement

● #1 Pre-Filter (Black)

● #2 Reverse Osmosis Membrane (Blue)

THIS PACKAGE CONTAINS THE PRE-FILTER AND REVERSE OSMOSIS MEMBRANE FOR YOUR TANKLESS REVERSE OSMOSIS SYSTEM. PLEASE FOLLOW THE STEPS BELOW TO REPLACE YOUR FILTERS.

Stage 2: Replacing #1 Pre-Filter and #2 Reverse Osmosis Membrane

NOTE: Your Pre-Filter and Reverse Osmosis Membrane will arrive in an encasing that is designed to make the filter change process as simple as possible.

#2
REVERSE OSMOSIS
MEMBRANE



#1
PRE-FILTER

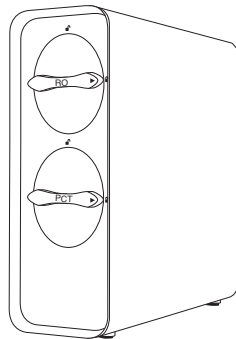

1

Grab the Pre-Filter by the handle and turn the filter counter-clockwise until the arrow points upwards and the filter slightly slides out.

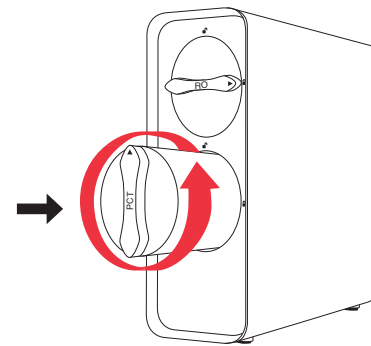

2

Pull the filter out and insert the new filter, ensuring the arrow aligns with the “unlocked symbol” before turning it clockwise and securing the new filter into place.

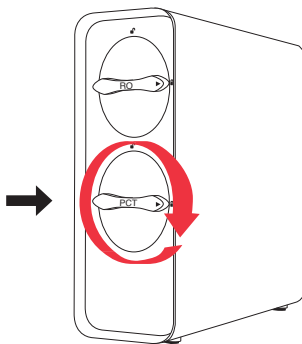

3

Repeat Step 1 for the Reverse Osmosis Membrane.

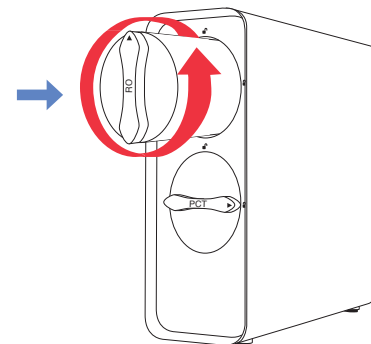

For more information please scan the QR code or visit **enercare.ca/tanklessfilters**



enercare®
Experts at home™

Tankless Reverse Osmosis System Filter Replacement

● #1 Pre-Filter (Black)

● #2 Reverse Osmosis Membrane (Blue)

THIS PACKAGE CONTAINS THE PRE-FILTER AND REVERSE OSMOSIS MEMBRANE FOR YOUR TANKLESS REVERSE OSMOSIS SYSTEM. PLEASE FOLLOW THE STEPS BELOW TO REPLACE YOUR FILTERS.

Stage 3: Pressure Test, Purge, and Filter Reset

NOTE: After reassembling the Tankless Reverse Osmosis System, follow the steps below to perform a pressure test, purge and filter reset before use.

1

Open the main shut-off valve on the cold water supply line by turning it clockwise.

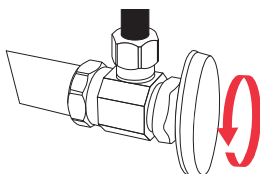

2

Let the water run out of the countertop faucet for 10-15 minutes forward for the Reverse Osmosis and another 10 -15 minutes backward for the purified side of the faucet.

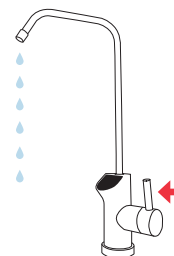

3

To reset the Pre-Filter and RO on **Model A**:

- Hold the “RESET” button for 3 seconds until you hear a beep then release.
 - Use the “RESET” button to select “PCT” (for Pre-Filter)
 - Press and hold the “RESET” button for 3 seconds to reset filter on the unit.
 - To reset the RO filter, repeat all the steps and select “RO” at step b above.
- Once both filters have been reset, the unit is ready to use.



3

To reset the Pre-Filter and RO on **Model B**:

- Hold the “RESET” button (red arrow “A”) for 3 seconds until you hear a beep then release.
 - Use the “SELECT” button (red arrow “B”) to select “PCT” (for Pre-Filter)
 - Press and hold the “RESET” button for 3 seconds to reset filter on the unit.
 - To reset the RO filter, repeat all the steps and select “RO” at step b above.
- Once both filters have been reset, the unit is ready to use.

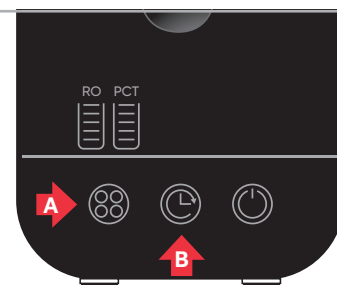

For more information please scan the QR code
or visit **enercare.ca/tanklessfilters**

PLEASE NOTE: You will be solely liable for any damage relating to such replacement, including the failure to follow the instructions and/or properly replace the filter/cartridge. If you require assistance, please contact Enercare to obtain a quote to complete such replacement for you.

™/©Enercare, Experts at home and the designs are trademarks of Enercare Inc., used under license.